

For construction, maintenance, cleaning and demolition risk refer to the relevant method statements and risk assessments related to this task for scheme Ref. C2016\_BC0001031\_08. In addition to the hazards/risks normally associated with the types of work detailed on this drawing take note of the following. All works on this drawing will be carried out by a competent contractor working to an appropriate method statement and risk assessment.

NOTES:

1. There were a total of 2905 individual pedestrian trips, only the top 13 origin/destination and 3 crossing movements are illustrated

- Pedestrian movements**
- 179 Pedestrians from Bell Lane West to Stratford Road
  - 160 Pedestrians from Bell Lane West to Bell Court/Concourse
  - 133 Pedestrians from Stratford Road to Bell Lane West
  - 119 movements from Stratford Road to Bell Lane School
  - 113 movements from Bell Lane West to Bell Lane East
  - 80 movements from Bell Lane West to Bell Court/Concourse
  - 72 movements from Green Lane North to Stratford Road
  - 62 movements from Green Lane North to Bell Lane East
  - 57 movements from Green Lane North to Bell Lane West
  - 56 movements Bell Lane East to Stratford Road
  - 43 movements from Belle Vue Road to Stratford Road
  - 36 movements from Bell Lane East to Alexandra Road
  - 32 movements from Alexandra Road to Bell Lane School

**Crossing movements**

- 57 crossing movements opposite 95b
- 39 crossing movements at the Bell Lane junction with Green Lane
- 147 crossing movements opposite Bell Lane Primary School

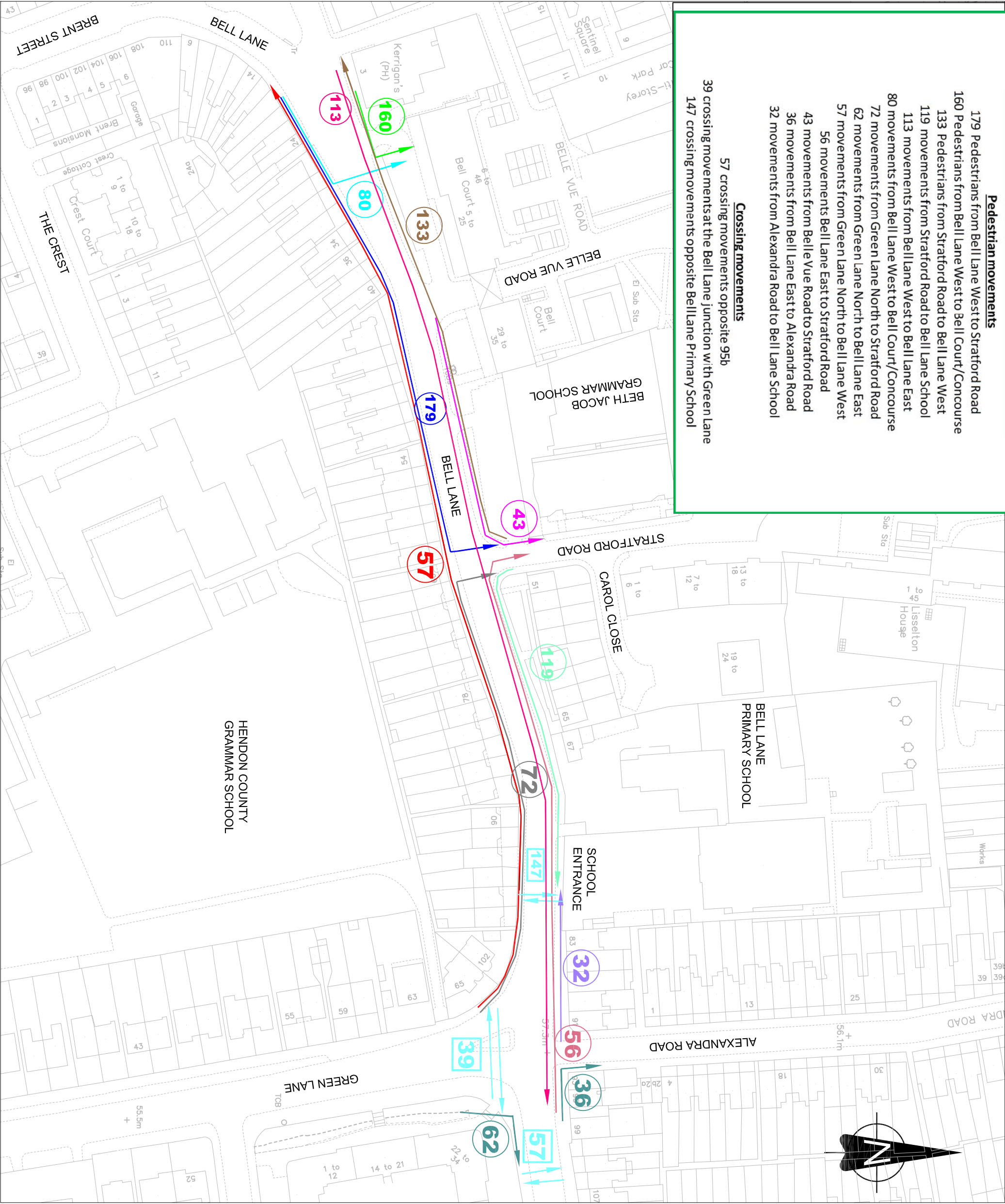

This product includes mapping data licensed from Ordnance Survey with the permission of the Controller of Her Majesty's Stationery Office.  
© Crown copyright and database right 2016. All rights reserved.  
London Borough of Barnet, Licence No 100017674

REVISION		
Initial Issue	Design/Check	Date
Purpose of Issue		

FOR INFORMATION

Client:



Re Scheme Ref. C2016\_BC/001031\_08  
Scheme file

BELL LANE, NW4

Drawing file

PEDESTRIAN TRACKING SURVEY

Scale @ A3:	
Design NI	Draw NI
Date: JAN 20	Date: JAN 20

